

RAMP SPRING ASSIST ASSEMBLIES & SERVICE PARTS

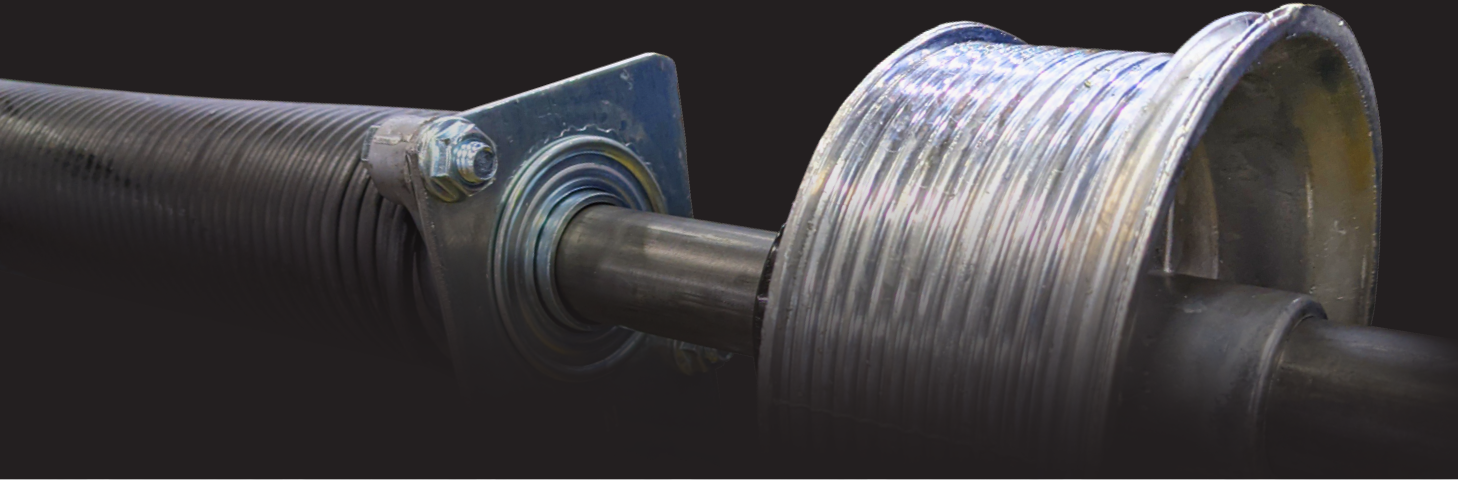

A North American Company



LYNX-NSW.COM

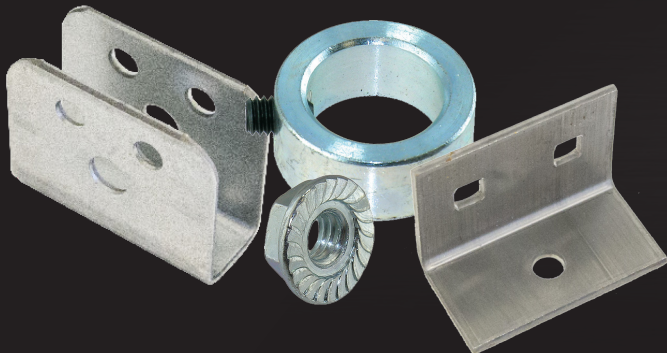

NSW  Lynx
Napoleon/Lynx[®]



Custom Engineered.

ASSEMBLED

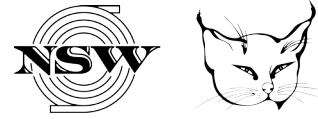

All of our Spring Assist Units can be quoted either by individual parts (bulk) or as an assembled unit. Contact your Napoleon/Lynx Outside Sales Representative or call us at a Napoleon/Lynx office with any questions and orders.

CUSTOM STENCILING to your exact specification.

SINGLE SPRING ASSEMBLY

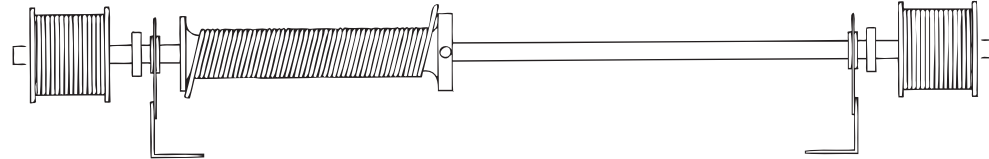

DOUBLE SPRING ASSEMBLY

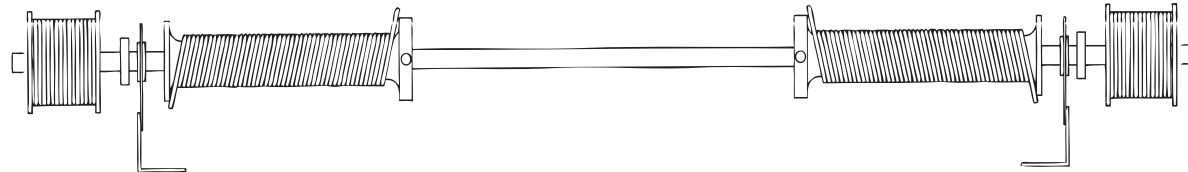
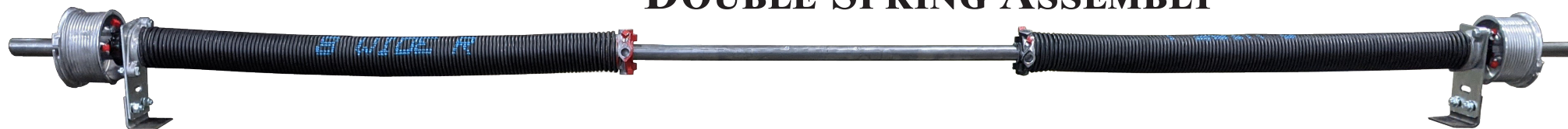

ASK ABOUT CUSTOM ENGINEERED SPRINGS FOR PLUS HEIGHT RAMP DOORS, AS WELL AS EXTRA HEAVY RAMP DOORS.

UNASSEMBLED

BRACKETS/PLATES	1-1/4" Cable Anchor Bracket Steel (3-48-3) Aluminum (3-48-7)	1/2" Cable Anchor Bracket 3-48-2	L-Bracket Steel (3-90-1) Aluminum (3-90-2)	Bearing Plate 2" (3-1-5) 2-5/8" (3-1-7) 3-3/4" (3-1-9)	
	3/8" x 3/4" Carriage Bolt 8-4-2	5/16" x 1" Machine Bolt 8-3-2	Whiz Nut 3/8" (8-4-4) 5/16" (8-3-6)	Cotter Pin 3/32" x 3/4" (8-5-2) 3/32" x 1" (8-5-1)	Clevis Pin 5/16" x 1" (8-3-9) 1/4" x 1" (8-2-19)
CABLES	Cable 7x7 - 110" (4-7-100) 7x7 - 130" (4-7-101) 7x7 - 150" (4-7-102) 7x7 - 190" (4-7-104)	1" Collar 15-6-11	1" Black Nylon Bushing 3-4-4	SAFETY SEALS 9-30-7	
	4-12 Drum 4-12 LH Red (2-14-4) 4-12 RH Black (2-14-3)	5-18 Drum 5-18 LH Red (2-15-3) 5-18 RH Black (2-15-2)	DRUMS RED/LH = Road Side BLACK/RH = Curb Side		

Custom for you.





14 GA

TUBE SHAFT

- 9-6-8 1" X 53" Tube Shaft 14GA
- 9-6-9 1" X 54" Tube Shaft 14GA
- 9-6-21 1" X 62" Tube Shaft 14GA
- 9-6-10 1" X 67" Tube Shaft 14GA
- 9-6-11 1" X 68" Tube Shaft 14GA
- 9-6-12 1" X 72" Tube Shaft 14GA
- 9-6-13 1" X 76" Tube Shaft 14GA
- 9-6-14 1" X 77" Tube Shaft 14GA
- 9-6-22 1" X 78" Tube Shaft 14GA
- 9-6-15 1" X 79" Tube Shaft 14GA
- 9-6-23 1" X 81" Tube Shaft 14GA
- 9-6-16 1" X 88" Tube Shaft 14GA
- 9-6-17 1" X 89" Tube Shaft 14GA
- 9-6-18 1" X 93" Tube Shaft 14GA
- 9-6-19 1" X 96" Tube Shaft 14GA
- 9-6-20 1" X 100" Tube Shaft 14GA

LENGTH OF "TEN" COILS IN INCHES = WIRE SIZE

1-3/4" = .177	2-3/4" = .273
1-7/8" = .1875	2-13/16" = .283
1-15/16" = .192	2-7/8" = .289
2-1/16" = .207	2-15/16" = .295
2-3/16" = .2187	3-1/16" = .3065
2-1/4" = .2253	3-1/8" = .3125
2-5/16" = .2343	3-3/16" = .3195
2-7/16" = .2437	3-5/16" = .331
2-1/2" = .250	3-7/16" = .3437
2-5/8" = .2625	3-5/8" = .3625

EXAMPLE

$$\frac{2-1/4"}{10} = .225$$

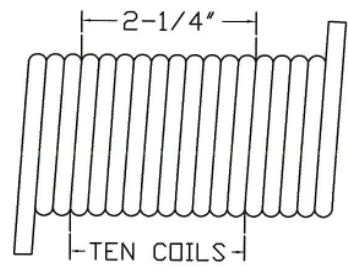

Left Hand Wound

Right Hand Wound

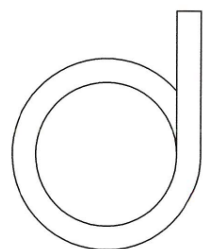
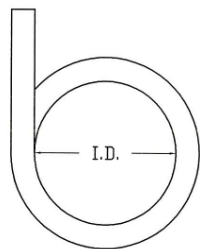

888-589-5969
QUEBEC
 175 Upper Eddison Ave.
 St. Lambert, QC
 J4R 2R3

888-839-5969
ONTARIO
 6311 Vipond Dr.
 Mississauga, ON
 L5T 1T7

800-233-3599
ARIZONA
 101 N. 57th Ave.
 Phoenix, AZ
 85043

800-234-5969
NEW JERSEY
 613 Industrial Rd.
 Carlstadt, NJ
 07072

800-338-5399
OHIO
 111 Weires Dr.
 Archbold, OH
 43502

